

RECORD of SURVEY for BOBBY E. TOLLETT 185 - O.R. - 155

BEING A RELOCATION OF A 30' ROAD & PUBLIC UTILITY EASEMENT AS SHOWN ON 14-M-79 &
LOCATED IN SECTION 2, T.6 N., R.11 E., M.D.M. - AMADOR COUNTY, CALIF. SCALE: 1" = 50' SEPT., 1981
TOMA & ANDERSON - LICENSED LAND SURVEYORS - 41 SUMMIT ST., JACKSON, CALIF.

SURVEYOR'S CERTIFICATE

THIS MAP CORRECTLY REPRESENTS A SURVEY MADE BY ME OR UNDER MY DIRECTION IN CONFORMANCE WITH THE REQUIREMENTS OF THE LAND SURVEYORS ACT AT THE REQUEST OF BOBBY E. TOLLETT IN SEPTEMBER OF 1981.

C. L. Jones
C1120 L. TDMA L.S. 3570

COUNTY SURVEYOR'S CERTIFICATE

THIS MAP HAS BEEN EXAMINED FOR CONFORMANCE WITH THE REQUIREMENTS OF THE LAND SURVEYORS ACT THIS 22nd DAY OF September, 1981.

Gary L. Caldwell BY C. LEE DELANGE L.S. 4066
GARY L. CALDWELL R.C.E. 20802 DEPUTY AMADOR COUNTY SURVEYOR
AMADOR COUNTY SURVEYOR

COMPLIANCE CERTIFICATE

THIS MAP HAS BEEN EXAMINE FOR COMPLIANCE WITH THE PROVISIONS OF THE SUBDIVISION MAP ACT AND ALL LOCAL ORDINANCES ENACTED PURSUANT THERETO.
DATE _____

RECORDERS CERTIFICATE

FILED THIS 5th DAY OF October, 1981, AT 4:25 P.M., IN BOOK 35 OF MAPS AND PLATS AT PAGE 18 AT THE REQUEST OF THE AMADOR COUNTY SURVEYOR.

6035
pd.
6.00

Sheldon D. Johnson BY: Mariana Arrese
SHELDON D. JOHNSON DEPUTY
AMADOR COUNTY RECORDER

NOTES & LEGEND

- DENOTES 5/8 INCH STEEL ROD TAGGED L.S. 3570 SET ON THIS SWIRLY.
- ⑤ DENOTES 12 INCH FORKED OAK TREE FOUND PER 14-M-79. AFFIXED BRASS TAG L.S. 3570.
- DENOTES 3/4 INCH STEEL ROD TAGGED R.C.E. 1706 FOUND PER 14-M-79.
- DENOTES 1/2 INCH STEEL ROD TAGGED L.S. 2902 FOUND PER 14-M-79.

THE MERIDIAN OF THIS SURVEY IS REFERRED TO THE SOUTH LINE OF PARCEL B AS SHOWN ON THAT CERTAIN OFFICIAL MAP RECORDED IN BOOK 14 OF MAPS AND PLATS AT PAGE 79, AMADOR COUNTY RECORDS, BEARING N. 88° 22' 22" E.

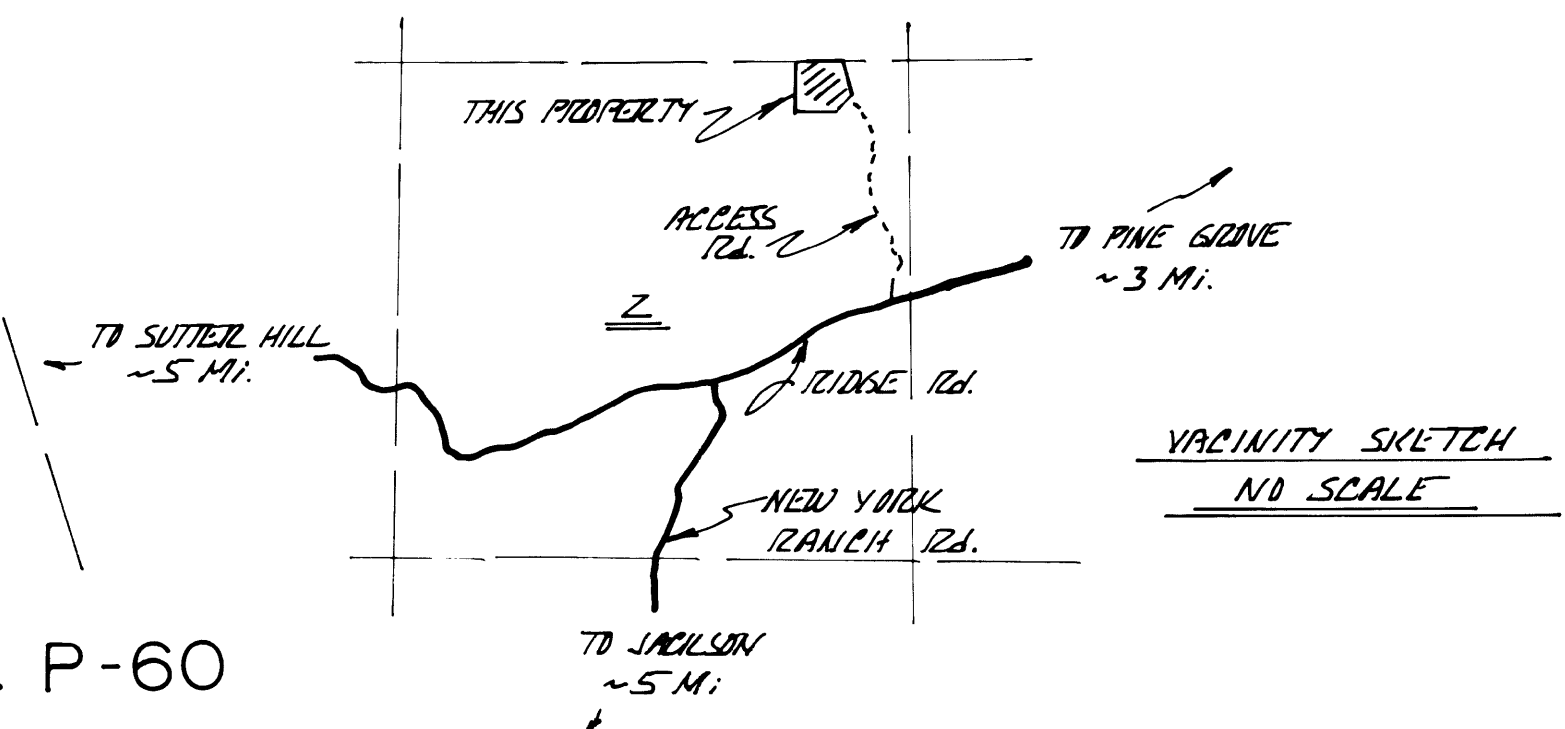

AMENDED BY 35-M & P-60