

LEGEND/REFERENCES:

- SET 1" IP WITH PLASTIC PLUG AND TACK "LS 7551"
- ⊗ SET #5 REBAR WITH CAP "LS 7551"
- FOUND 2-1/2" BRASS DISK IN MONUMENT WELL, NO PUNCH
- FOUND 3/4" IP WITH PLASTIC PLUG, BRASS TAG, AND TACK "RCE 10307" PER (1), UNLESS OTHERWISE NOTED.
- (1) BOOK 351 MAPS 1-2
- (2) DOC. 12902157
- (3) DOC. 21031859
- (4) CORNER RECORD 1516
- O.R. OFFICIAL RECORDS
- SUBJECT PROPERTY LINES
- - - STREET CENTERLINE
- - - RIGHT OF WAY/LOT LINE

REASON FOR MANDATORY FILING  
LAND SURVEYORS ACT SECTION 8762 (b)(4)

SURVEYOR'S STATEMENT

THIS MAP CORRECTLY REPRESENTS A SURVEY MADE BY ME OR UNDER MY DIRECTION IN CONFORMANCE WITH THE REQUIREMENTS OF THE PROFESSIONAL LAND SURVEYORS' ACT AT THE REQUEST OF ASHLE BERINGER IN DECEMBER, 2018.



BRYAN G. TAYLOR L.S. #7551  
DATE 05-MARCH-2021

COUNTY SURVEYOR'S STATEMENT

THIS MAP HAS BEEN EXAMINED IN ACCORDANCE WITH SECTION 8766 OF THE PROFESSIONAL LAND SURVEYORS' ACT THIS 24th DAY OF MARCH, 2021.

AUGUST HANKS, P.L.S. #9274  
COUNTY SURVEYOR



BY: JEREMY KOENIG, DEPUTY COUNTY SURVEYOR, P.L.S. #9394

COUNTY RECORDER'S STATEMENT

FILED THIS 25 DAY OF March 2021 AT 3:12 P.M. IN BOOK 937 OF MAPS AT PAGE 16 AT THE REQUEST OF BRYAN G. TAYLOR, INC.  
FILE NO. 24892157 FEE \$83.00

REGINA ALCOMENDRAS, COUNTY RECORDER

BY: Laura S. Aguilar  
DEPUTY COUNTY RECORDER

BASIS OF BEARINGS:

THE BEARING, NORTH 51°43'39" EAST, AS CALCULATED BETWEEN THE TWO MONUMENTS FOUND, OF THE CENTERLINE OF W. LOYOLA DRIVE, AS SHOWN ON THAT CERTAIN SUBDIVISION MAP ENTITLED "TRACT NO. 5618 CINNABAR HILLS" WHICH WAS FILED FOR RECORD IN BOOK 351 OF MAPS PAGES 1-2, SANTA CLARA COUNTY RECORDS, WAS USED AS THE BASIS OF BEARINGS FOR THIS SURVEY.

COUNTY GRID NO. 63-15-69

RECORD OF SURVEY

PARCEL 1 PER N865 O.R. 1931  
PORTION OF LOT 3, BOOK 351 MAPS 1-2  
"TRACT NO. 5618 CINNABAR HILLS"  
[10850 W. LOYOLA DRIVE]  
LOS ALTOS HILLS SANTA CLARA COUNTY CALIFORNIA  
SCALE: 1" = 20' SEPTEMBER, 2020

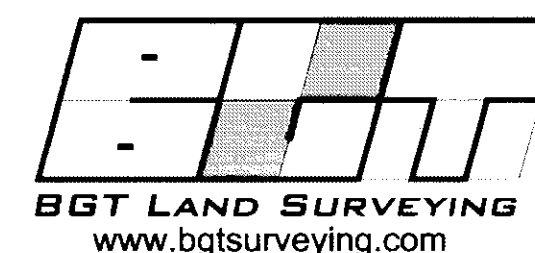

SHEET 1 OF 1 JOB: 17-024

24892157

BK 937  
Pg 16

16