

OWNERSHIP STATEMENT

We the undersigned, being all parties having any record title interest in the real property being subdivided, do hereby consent to the preparation and recordation of this final map.

We also reserve to ourselves, our heirs, and assigns, a certain private road and drainage easement designated as Lot 'A', certain private drainage easements, certain private snow storage easements and certain private fairway setback easements for the use and benefit of the present and future owners of the lots affected by such easements as delineated on said map.

As owners:

Starwood Partners, A California General Partnership,

By: Lodestar Company, A California Corporation, its General Partner

By: Henry P. Acuff
Henry P. Acuff, President

As Trustee:

Inyo-Mono Title Company, a California Corporation as trustee under Deed of Trust recorded in Volume 746 at Page 093 of Official Records of Mono County, on September 18, 1996.

James D. Core
James D. Core, President

State of CA.
County of ORANGE

On April 30, 1998 before me,

William L. Wilson
a Notary Public in and for said County and State, personally appeared
Henry P. Acuff

☐ personally known to me - OR - ☒ proved to me on the basis of satisfactory evidence to be the person(s) whose name(s) is/are subscribed to the within instrument and acknowledged to me that he/she/they executed the same in his/her/their authorized capacity(ies), and that by his/her/their signature(s) on the instrument the person(s), or the entity upon behalf of which the person(s) acted, executed the instrument.

WITNESS my hand and (optional) official seal:

William L. Wilson
Notary Public (sign and print name)
My commission expires: Feb 14, 2002
County of my principal place of business: ORANGE

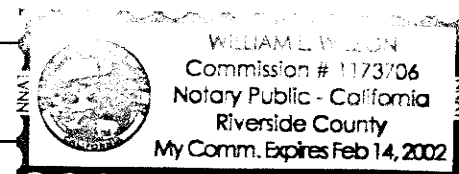

State of CALIF.
County of MONO

On April 27, 1999 before me,

Janice Mary Johnson
a Notary Public in and for said County and State, personally appeared
James D. Core

☒ personally known to me - OR - ☐ proved to me on the basis of satisfactory evidence to be the person(s) whose name(s) is/are subscribed to the within instrument and acknowledged to me that he/she/they executed the same in his/her/their authorized capacity(ies), and that by his/her/their signature(s) on the instrument the person(s), or the entity upon behalf of which the person(s) acted, executed the instrument.

WITNESS my hand and (optional) official seal:

Janice Mary Johnson
Notary Public (sign and print name)
My commission expires: 10/25/02
County of my principal place of business: Mono

PLANNING COMMISSION'S CERTIFICATE

This final map has been reviewed by the undersigned and found to be in substantial conformance with the approved or conditionally approved tentative map.

Therefore, in accordance with the provisions of the Town of Mammoth Lakes Resolution 84-10, Section 17.20.170, this map is hereby approved.

Said approval having been ratified by the Town of Mammoth Lakes Planning Commission on May 12, 1999.

By: William T. Taylor
William T. Taylor, Secretary of the Planning Commission

TAX COLLECTOR'S CERTIFICATE

I hereby certify that, according to the records on file in this office, there are no liens against this subdivision, or any part thereof, for unpaid state, county, municipal, local taxes or special assessments collected as taxes, except taxes or special assessments not yet payable. Taxes or special assessments collected as taxes which are a lien but not yet payable are estimated to be in the amount of \$ 17,063.27 for which receipt of good and sufficient security conditioned upon payment of these taxes is hereby acknowledged.

Shirley A. Cranney
Mono County Tax Collector

5/27/99
Date

By: Stacey Rosterlund
Deputy Mono County Tax Collector

SURVEYOR'S STATEMENT

I hereby state that this final map and survey were made by me or under my direction; that the survey made during July, 1995 is true and complete as shown; that all the monuments are of the character and occupy the positions indicated, or will be set in such positions by Dec. 1999 and that such monuments are sufficient to enable the survey to be retraced.

April 27 1999
Date

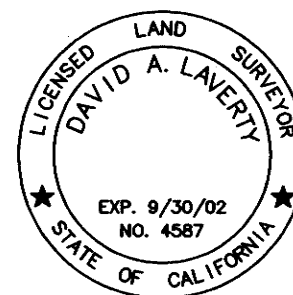

David A. Lavery
David A. Lavery L.S. 4587
Lic. exp. 9/30/02

TOWN ENGINEER'S STATEMENT

This map has been examined by me and the subdivision as shown is substantially the same as it appeared on the tentative map, and any approved alterations thereof. All provisions of the Subdivision Map Act and any local ordinances applicable at the time of approval of the tentative map have been complied with.

Town Engineer:

May 21, 1999
Date

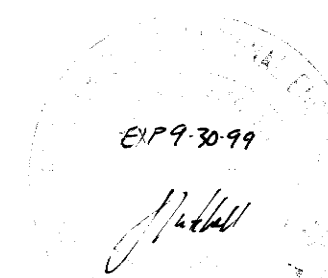

Jeffrey L. Mitchell
JEFFREY L. MITCHELL R.C.E. 35134
Mammoth Lakes Town Engineer
Lic. exp. 9/30/99

RECORDER'S CERTIFICATE

Filed this 28th day of May, 1999 at 11:33 A.M., in Book 10 of Tract Maps at Page 47-47C, at the request of The Lodestar Co.

Instrument No. #4165 Fee: \$16.00

Renn Nolan
Mono County Recorder

By: Vera M. Miller
Deputy Mono County Recorder

TOWN SURVEYOR'S STATEMENT

This final map was examined by me and I am satisfied that this map is technically correct.

5/21/99
Date

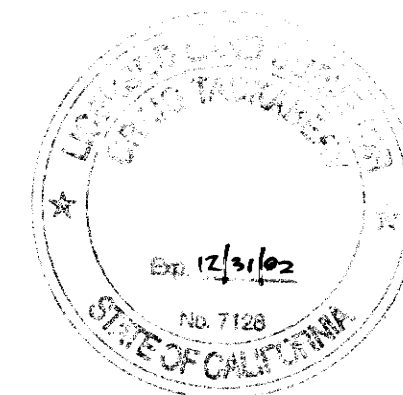

Craig E. Tackabery
CRAIG E. TACKABERY P.L.S. 7128
Mammoth Lakes Town Surveyor
Lic. exp. 12/31/02

C.C. & R.'s NOTE

The declarations of covenants, conditions, restrictions and reservations are recorded in Volume 679 at Page 170 and Modified in Volume 806 at Page 367 of Official Records on file in the office of the Mono County Recorder.

SOILS NOTE

A soils report was prepared in July 1991, by Sierra Geotechnical Services, Inc., under the signature of Thomas A. Platz, R.C.E. 41039. Said report is on file with the Town of Mammoth Lakes Public Works Department.

SIGNATURE OMISSIONS

The signatures of the following companies, their successors and assigns, owners of easements or interests as disclosed by the following deeds recorded in the Official Records of Mono County, have been omitted under the provisions of Section 66436 Subsection a-3Ai of the Subdivision Map Act:

Continental Telephone Company of California 370/593 O.R. recorded 12-8-82

That interest reserved by the United States of America, USA patent recorded 4-20-12, per "Q"/546 O.R. is included in this map, without consent, under the provisions of Section 66436, Subsection a-4 of the Subdivision Map Act.

STARWOOD SUBDIVISION - PHASE II
TRACT NO. 36-171B
A PLANNED UNIT DEVELOPMENT

BEING A SUBDIVISION OF LOT LINE ADJUSTMENT PARCEL 8 per 746/77 O.R., SHOWN ON RECORD OF SURVEY NO. 36-124 RECORDED IN BOOK 3 OF RECORD OF SURVEY MAPS AT PAGE 43-43D, AS RECORDED IN THE OFFICE OF THE COUNTY RECORDER MONO COUNTY, IN THE STATE OF CALIFORNIA. LOCATED IN THE TOWN OF MAMMOTH LAKES.