

EXHAUST FAN INFORMATION – JOB#4848007

FAN UNIT NO	TAG	QTY	FAN UNIT MODEL #	MANUFACTURER	CFM	ESP	RPM	MOTOR ENCL	HP	BHP	PHASE	VOLT	FLA	DISCHARGE VELOCITY	WEIGHT (LBS)	SDNES
1		1	EABDU18	ECON-AIR	3450	1.250	1223	DDP	2.000	1.3860	3	208	5.9	797 FPM	189	17.6
2		1	EABDU18	ECON-AIR	3450	1.250	1223	DDP	2.000	1.3860	3	208	5.9	797 FPM	189	17.6
3		1	EABDCR7	ECON-AIR	450	0.250	1128	DDP	0.250	0.0850	1	115	4.8		90	6.3

MUA FAN INFORMATION – JOB#4848007

FAN UNIT NO	TAG	QTY	FAN UNIT MODEL #	BLOWER	HOUSING	MIN CFM	DESIGN CFM	ESP	RPM	MOTOR ENCL	HP	BHP	PHASE	VOLT	FLA	MCA	MDCP	WEIGHT (LBS)	SDNES
4		1	EA3-D.500-G18	G18-PB	A3-D.500	3500	5520	0.750	783	DDP,PREMIUM	5.000	2.5730	3	208	15.0	18.8A	30A	852	13.5

GAS FIRED MAKE-UP AIR UNIT(S)

FAN UNIT NO	TAG	INPUT BTUs	OUTPUT BTUs	TEMP RISE	REQUIRED INPUT GAS PRESSURE	GAS TYPE	BURNER EFFICIENCY(%)
4		590400	543168	100°F	7 IN. W.C. – 14 IN. W.C.	NATURAL	92

FAN OPTIONS

FAN UNIT NO	TAG	QTY	DESCRIPTION
1		1	GREASE BOX.
		1	UPBLAST FAN WHEEL ACCESS PORT.
		1	FAN BASE CERAMIC SEAL – INSTALLED AT PLANT – FOR GREASE DUCTS.
		1	2 YEAR PARTS WARRANTY.
2		1	GREASE BOX.
		1	UPBLAST FAN WHEEL ACCESS PORT.
		1	FAN BASE CERAMIC SEAL – INSTALLED AT PLANT – FOR GREASE DUCTS.
		1	2 YEAR PARTS WARRANTY.
3		1	I 15-BDD DAMPER.
		1	2 YEAR PARTS WARRANTY.
		1	AC INTERLOCK RELAY – 24VAC COIL.
		1	LOW FIRE START.
4		1	INLET PRESSURE GAUGE, 0–35".
		1	MANIFOLD PRESSURE GAUGE, –5 TO 15" W.C.
		1	MOTORIZED BACKDRAFT DAMPER FOR A3-D HOUSING. MEETS AMCA CLASS 1A RATING.
		1	FREEZESTAT (10).
		1	SEPARATE 120V WIRING PACKAGE (REQUIRED AND USED ONLY FOR DCV OR PREWIRE WITH VFD) – THREE PHASE ONLY.
		1	2 YEAR PARTS WARRANTY.

FAN ACCESSORIES

FAN UNIT NO	TAG	EXHAUST				SUPPLY			
		GREASE CUP	GRAVITY DAMPER	WALL MOUNT	SIDE DISCHARGE	GRAVITY DAMPER	MOTORIZED DAMPER	WALL MOUNT	
1		YES							
2		YES							
3			YES						
4							YES		

CONTRACTOR TO PROVIDE GREASE RATED EXHAUST FAN BASE CERAMIC SEAL BETWEEN EXHAUST FAN AND GREASE DUCT IN ACCORDANCE WITH IMC 2015 SECTION 506.3.2.3

CURB ASSEMBLIES

NO	ON FAN	WEIGHT	ITEM	SIZE
1	# 1	34 LBS	CURB	26.500"W X 26.500"L X 30.000"H VENTED HINGED.
2	# 2	34 LBS	CURB	26.500"W X 26.500"L X 30.000"H VENTED HINGED.
3	# 3	18 LBS	CURB	19.500"W X 19.500"L X 12.000"H .
4	# 4	84 LBS	CURB	35.000"W X 84.000"L X 20.000"H INSULATED.

FANS #1, #2 – EABDU18 EXHAUST FAN

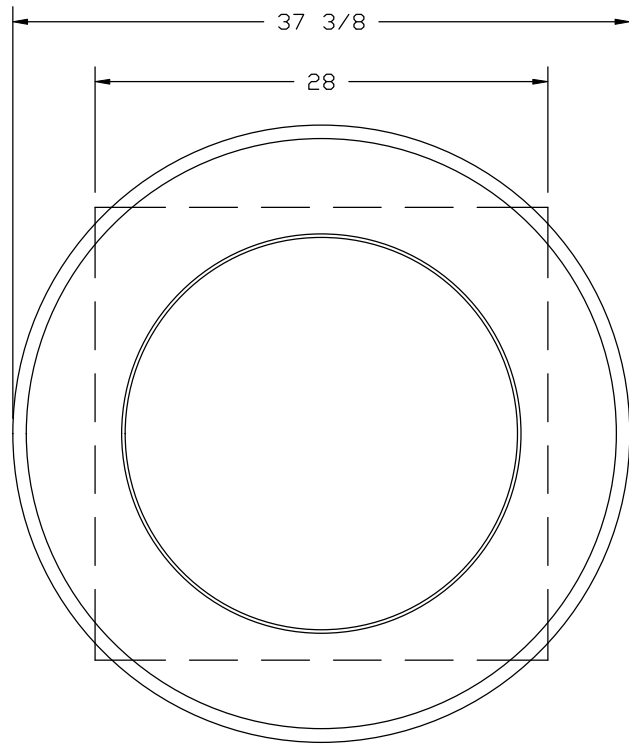
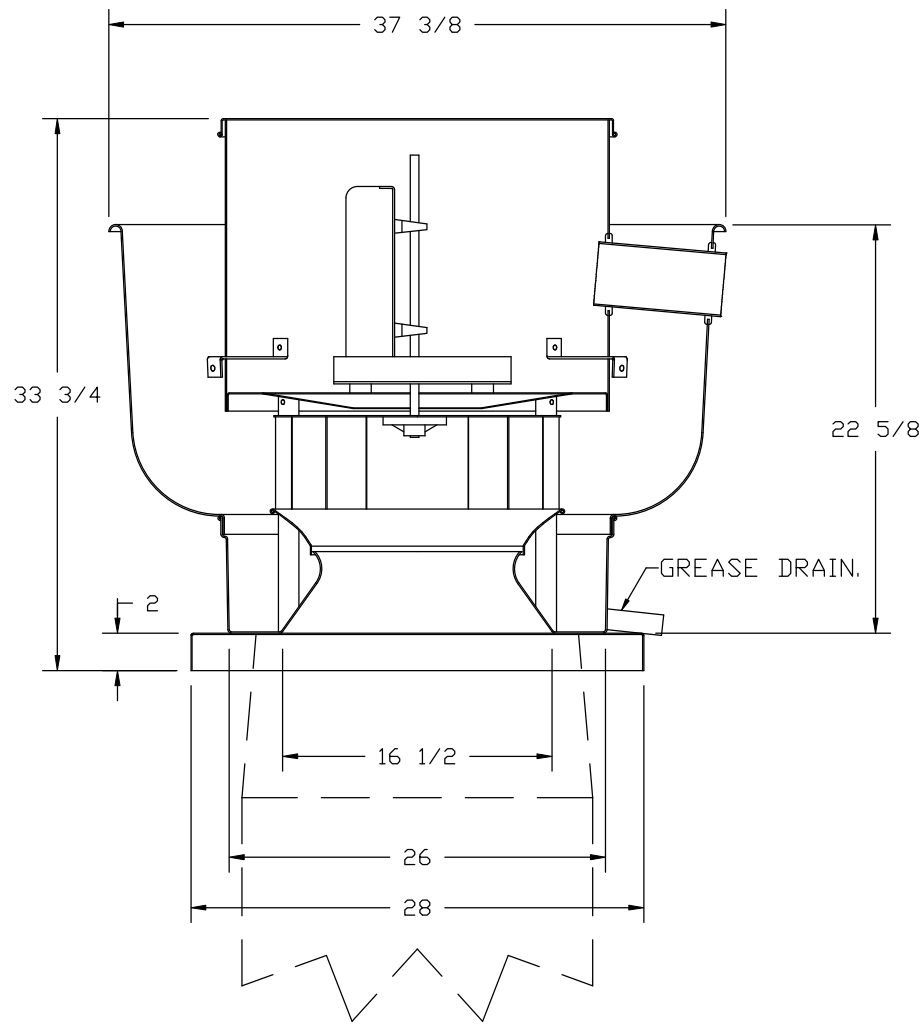

TOP VIEW

FEATURES:

- ROOF MOUNTED FANS.
- RESTAURANT MODEL.
- UL705 AND UL762 AND ULC-S645.
- AMCA SOUND AND AIR CERTIFIED.
- WIRING FROM MOTOR TO DISCONNECT SWITCH.
- NEMA 3R SAFETY DISCONNECT SWITCH.
- HIGH HEAT OPERATION 300°F (149°C).
- GREASE CLASSIFICATION TESTING.

NORMAL TEMPERATURE TEST
EXHAUST FAN MUST OPERATE CONTINUOUSLY WHILE EXHAUSTING AIR AT 300°F (149°C) UNTIL ALL FAN PARTS HAVE REACHED THERMAL EQUILIBRIUM, AND WITHOUT ANY DETERIORATING EFFECTS TO THE FAN WHICH WOULD CAUSE UNSAFE OPERATION.

ABNORMAL FLARE-UP TEST
EXHAUST FAN MUST OPERATE CONTINUOUSLY WHILE EXHAUSTING BURNING GREASE VAPORS AT 600°F (316°C) FOR A PERIOD OF 15 MINUTES WITHOUT THE FAN BECOMING DAMAGED TO ANY EXTENT THAT COULD CAUSE AN UNSAFE CONDITION.

OPTIONS

- GREASE BOX.
- UPBLAST FAN WHEEL ACCESS PORT.
- FAN BASE CERAMIC SEAL – INSTALLED AT PLANT – FOR GREASE DUCTS.
- 2 YEAR PARTS WARRANTY.

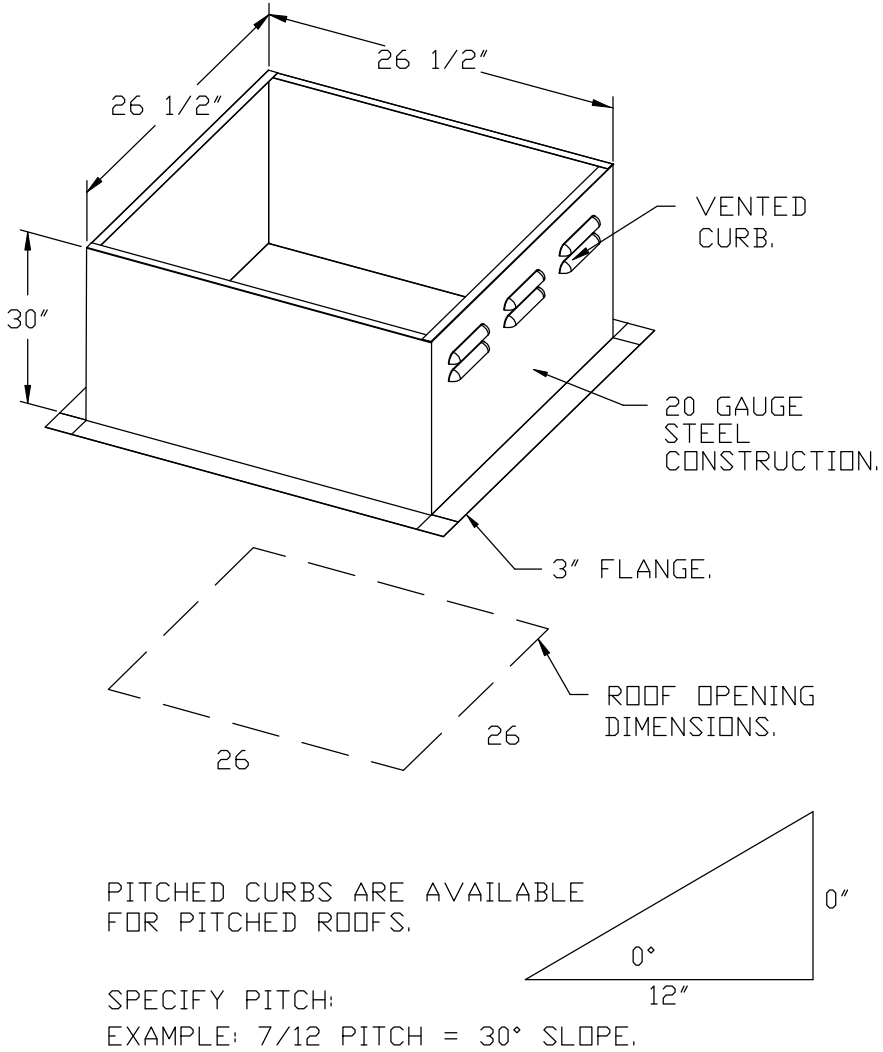

COORDINATE FINAL LOCATION OF GREASE RATED EXHAUST FANS AND MAKEUP AIR UNITS IN ACCORDANCE WITH THE REQUIREMENTS OF IMC 2012 SECTION 506.3.13. OUTLETS SHALL TERMINATE NOT LESS THAN 40 INCHES ABOVE ROOF SURFACE, NOT LESS THAN 10 FEET HORIZONTALLY FROM PARTS OF THE SAME OR CONTIGUOUS BUILDINGS, ADJACENT BUILDINGS AND ADJACENT PROPERTY LINES, AND NOT LESS THAN 10 FEET ABOVE THE ADJOINING GRADE LEVEL. OUTLETS SHALL BE LOCATED NOT LESS THAN 10 FEET HORIZONTALLY FROM OR NOT LESS THAN 3 FEET VERTICALLY ABOVE AIR INTAKE OPENINGS INTO ANY BUILDING. EXCEPTION OUTLETS SHALL TERMINATE NOT LESS THAN 5 FEET HORIZONTALLY FROM PARTS OF THE SAME OR CONTIGUOUS BUILDING, ADJACENT BUILDINGS AND ADJACENT PROPERTY LINES AND AIR INTAKE OPENINGS INTO A BUILDING WHERE AIR FROM THE EXHAUST OUTLET IS DISCHARGED AWAY FROM SUCH LOCATIONS.

COORDINATE FINAL LOCATION OF NON GREASE RATED EXHAUST FANS IN ACCORDANCE WITH THE REQUIREMENTS OF IMC 2012 SECTION 506.4.2. OUTLETS SHALL TERMINATE NOT LESS THAN 30 INCHES ABOVE ROOF SURFACE AND FROM EXTERIOR VERTICAL WALLS, NOT LESS THAN 3 FEET IN ANY DIRECTION FROM OPENINGS INTO THE BUILDING, AND NOT LESS THAN 10 FEET ABOVE GRADE OR FROM PROPERTY LINES OR BUILDINGS ON THE SAME LOT. OUTLETS SHALL NOT BE DIRECTED ONTO WALKWAYS, SHALL BE PROTECTED AGAINST LOCAL WEATHER CONDITIONS, AND SHALL MEET THE PROVISIONS FOR EXTERIOR WALL OPENING PROTECTIVES IN ACCORDANCE WITH THE INTERNATIONAL BUILDING CODE.

MAKEUP AIR TEMPERATURE SHALL BE DELIVERED WITHIN 10 DEGREES OF ROOM TEMPERATURE AS PER IMC 2012 SECTION 508.1.1, EXCEPT WHERE ADDITIONAL HEATING AND COOLING LOADS OF THE MAKEUP AIR DO NOT EXCEED THE CAPACITY OF THE HVAC SYSTEM.

NOTE: UNLESS OTHERWISE STATED, PANDA RESTAURANT GROUP SHALL PROVIDE ALL EQUIPMENT ON THE FOLLOWING CAPTIVEAIRE SHEETS, INCLUDING: HOODS, FIRE SYTEM, EXHAUST FANS, SUPPLY FAN, BATHROOM FAN AND ELECTRICAL INTERLOCK PACKAGE

DOUBLE WALL DUCT BY MECHANICAL PLEASE USE CONTACT BELOW FOR PRICING

ANSUL GAS VALVE:

THE ANSUL GAS VALVE IS PROVIDED BY CAPTIVEAIRE SYSTEMS. CONTACT OUR OFFICE WITH THE VALVE SIZE 3 DAYS IN ADVANCE OF WHEN IT IS NEEDED ON SITE.

FOR QUESTIONS CALL THE CAPTIVEAIRE SOUTHERN CALIFORNIA OFFICE

3002 DOW AVENUE, SUITE 410
TUSTIN, CA 92780
TEL: 714-957-1500 EMAIL: REG66@CAPTIVEAIRE.COM

REVISIONS

DESCRIPTION	DATE:

www.captiveaire.com

www.captiveaire.com

Southern California Office

3002 Dow Ave., Suite 410, Tustin, CA, 92780 PHONE: (714) 957-1500 FAX: (919) 227-5975 EMAIL: reg66@captiveaire.com

Panda Express – Westfield IN (D8060)

390 W Spring Mill Pointe Dr,
Westfield, IN, 46074

DATE: 5/21/2021

DWG.#:
4848007

DRAWN BY: AH-86

SCALE:
NO SCALE

MASTER DRAWING

SHEET NO.

5