

# CORNER RECORD

COUNTY OF ~~HYD~~ MONO T. 6N R. 24E MDB MERIDIAN CALIFORNIA  
 CORNER TYPE: GOV'T. CORNER ☐ MEANDER ☐ RANCHO ☐ CONTROL ☐ OTHER ☒  
 CORNER IDENTIFICATION - DATE OF VISIT MARCH 2 19 88

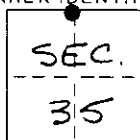

N 1/4 SEC 35 - Pt. # 203

CORNER - LEFT AS FOUND ☒ FOUND AND TAGGED ☐ REESTABLISHED OBLITERATED CORNER ☐ REBUILT ☐

PHYSICAL DESCRIPTION OF CORNER FOUND: EVIDENCE AND METHOD USED TO IDENTIFY OR REESTABLISH FOUND ROCK  
MOUND- SET 2"x2" HUB w/TACK IN CENTER, LOCATED 2200' ± E. OF C/L  
MONO 395, 1300' ± W. OF BARBWIRE FENCE, 1000' ± W. OF BASE OF SAGE-  
BRUSH COVERED HILL AT W. SIDE OF GRASSY MEADOW. Cal Trans  
brass tag set with tack.

PHYSICAL DESCRIPTION OF MONUMENTS REBUILT OR PERPETUATED PHOTO INFO- ROLL# 221400/4  
EXP.#1- FACING WEST LOOKING DOWN  
EXP.#2- FACING WEST  
EXP.#3- FACING EAST  
EXP.#4- FACING NORTH

CALIFORNIA COORDINATE SYSTEM ORDER: FIRST ☐ SECOND ☐ THIRD ☒ ASSUMED COORS.  
 STATIONS USED: NGS (USC & GS) ☐ STATE ☒ COUNTY ☐ OTHER ☐ STATION \_\_\_\_\_ STATION \_\_\_\_\_  
 ZONE \_\_\_\_\_ ELEVATION \_\_\_\_\_ NORTHINGS (Y) 102,490.8 ± EASTINGS (X) 101,532.5 ±

SKETCH: (Include reference tie or witness points, remarks and topo of area)

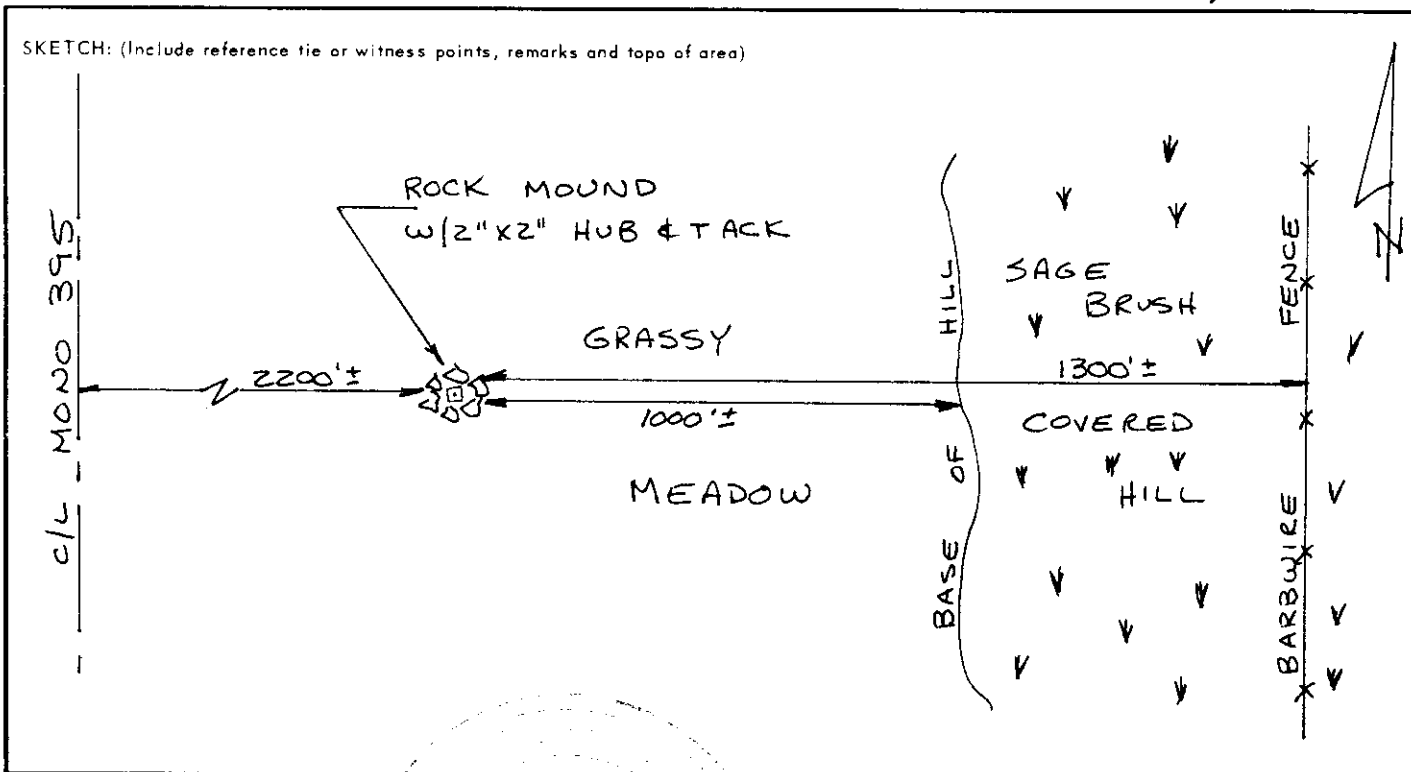

## SURVEYOR'S CERTIFICATE

THIS CORNER RECORD WAS PREPARED BY ME OR UNDER MY DIRECTION IN CONFORMANCE WITH THE LAND SURVEYORS ACT ON MARCH 2 19 88

SIGNED: [Signature] 9/30/89

L.S. or R.C.E. No.: 1468

SEAL

## COUNTY SURVEYOR'S CERTIFICATE

THIS CORNER RECORD WAS RECEIVED 5-12 19 90 AND EXAMINED AND FILED 5-4 19 90

BY: [Signature]

TITLE: MONO COUNTY Surveyor

DOCUMENT No. 6N24-35-1

STATEMENT ON BACK OF SHEET

YES ☐ NO ☒